

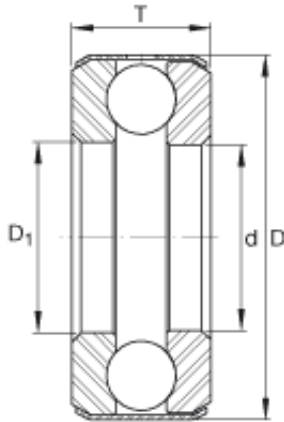

Baochen Machinery Technology Co., Ltd



INA D7 thrust ball bearings

Bearing No. D7

Size	22.225x46.838x15.875 mm
Bore Diameter	22,225 mm
Outer Diameter	46,838 mm
Width	15,875 mm
d	7/8 inch
d	22,225 mm
D	1,844 inch
D	46,838 mm
T	0,625 inch
T	15,875 mm
D ₁	0,906 inch
m	0,28 lbs / Weight
m	127 g / Weight
C _a	6600 lbf / Dynamic load rating (axial)
C _a	29400 N / Dynamic load rating (axial)
C _{0a}	12200 lbf / Static load rating (axial)
C _{0a}	54000 N / Static load rating (axial)
Category	Thrust Ball Bearing
Inventory	0.0
Manufacturer Name	SCHAEFFLER GROUP
Minimum Buy Quantity	N/A
Weight / Kilogram	0
EAN	4012802034721

D7 Bearing 2D drawings and 3D CAD models



Baochen Machinery Technology Co., Ltd

Product Group	B04270
Rolling Element	Ball Bearing
Thrust Bearing	Yes
Single or Double Direction	Single Direction
Banded	Yes
Cage Material	Steel
Precision Class	ABEC 1 ISO P0
Component Description	Roller Assembly Plus Raceways
Other Features	Single Row
Long Description	7/8" Bore 1; 29/32" Bore 2; 1-27/32" Outside Diameter; 5/8" Height; Ball Bearing; Single Direction; Banded; Steel Cage; ABEC 1 ISO P0 Precision
Inch - Metric	Inch
Category	Thrust Ball Bearings
UNSPSC	31171552
Harmonized Tariff Code	8482.10.50.08
Noun	Bearing
Keyword String	Ball Thrust
Manufacturer URL	http://www.ina.com
Weight / LBS	0.278
Overall Height with Aligning Washer	0 Inch 0 Millimeter
Bore 1	0.875 Inch 22.225 Millimeter
Outside Diameter	1.844 Inch 46.838 Millimeter
Height	0.625 Inch 15.875 Millimeter
Bore 2	0.906 Inch 23.012 Millimeter